

AGMA 9002-A86 Inch Bore and ANSI B17.1 Square Keyway Tolerances

Bore Diameter Size			Bore	Keyway Width (w)		Keyway Height (d) Reference	(t) - DIM -0.000 / +0.010
3/8	.3750	<u>Minimum</u> <u>Maximum</u>	<u>0.3750</u> <u>0.3760</u>	3/32	<u>0.0938</u> <u>0.0958</u>	0.0469	<u>0.421</u> <u>0.431</u>
7/16	.4375	<u>Minimum</u> <u>Maximum</u>	<u>0.4375</u> <u>0.4385</u>	3/32	<u>0.0938</u> <u>0.0958</u>	0.0469	<u>0.484</u> <u>0.494</u>
1/2	0.5000	<u>Minimum</u> <u>Maximum</u>	<u>0.5000</u> <u>0.5010</u>	1/8	<u>0.1250</u> <u>0.1270</u>	0.0625	<u>0.560</u> <u>0.570</u>
9/16	.5625	<u>Minimum</u> <u>Maximum</u>	<u>0.5625</u> <u>0.5635</u>	1/8	<u>0.1250</u> <u>0.1270</u>	0.0625	<u>0.623</u> <u>0.633</u>
5/8	.6250	<u>Minimum</u> <u>Maximum</u>	<u>0.6250</u> <u>0.6260</u>	3/16	<u>0.1875</u> <u>0.1895</u>	0.0938	<u>0.709</u> <u>0.719</u>
11/16	.6875	<u>Minimum</u> <u>Maximum</u>	<u>0.6875</u> <u>0.6885</u>	3/16	<u>0.1875</u> <u>0.1895</u>	0.0938	<u>0.773</u> <u>0.783</u>
3/4	.7500	<u>Minimum</u> <u>Maximum</u>	<u>0.7500</u> <u>0.7510</u>	3/16	<u>0.1875</u> <u>0.1895</u>	0.0938	<u>0.837</u> <u>0.847</u>
13/16	.8125	<u>Minimum</u> <u>Maximum</u>	<u>0.8125</u> <u>0.8135</u>	3/16	<u>0.1875</u> <u>0.1895</u>	0.0938	<u>0.900</u> <u>0.910</u>
7/8	.8750	<u>Minimum</u> <u>Maximum</u>	<u>0.8750</u> <u>0.8760</u>	3/16	<u>0.1875</u> <u>0.1895</u>	0.0938	<u>0.964</u> <u>0.974</u>
15/16	.9375	<u>Minimum</u> <u>Maximum</u>	<u>0.9375</u> <u>0.9385</u>	1/4	<u>0.2500</u> <u>0.2520</u>	0.1250	<u>1.051</u> <u>1.061</u>
1.0000	1.0000	<u>Minimum</u> <u>Maximum</u>	<u>1.0000</u> <u>1.0010</u>	1/4	<u>0.2500</u> <u>0.2520</u>	0.1250	<u>1.114</u> <u>1.124</u>
1 1/16	1.0625	<u>Minimum</u> <u>Maximum</u>	<u>1.0625</u> <u>1.0635</u>	1/4	<u>0.2500</u> <u>0.2520</u>	0.1250	<u>1.178</u> <u>1.188</u>
1 1/8	1.1250	<u>Minimum</u> <u>Maximum</u>	<u>1.1250</u> <u>1.1260</u>	1/4	<u>0.2500</u> <u>0.2520</u>	0.1250	<u>1.241</u> <u>1.251</u>
1 3/16	1.1875	<u>Minimum</u> <u>Maximum</u>	<u>1.1875</u> <u>1.1885</u>	1/4	<u>0.2500</u> <u>0.2520</u>	0.1250	<u>1.304</u> <u>1.314</u>
1 1/4	1.2500	<u>Minimum</u> <u>Maximum</u>	<u>1.2500</u> <u>1.2510</u>	1/4	<u>0.2500</u> <u>0.2520</u>	0.1250	<u>1.367</u> <u>1.377</u>
1 5/16	1.3125	<u>Minimum</u> <u>Maximum</u>	<u>1.3125</u> <u>1.3135</u>	5/16	<u>0.3125</u> <u>0.3145</u>	0.1563	<u>1.455</u> <u>1.465</u>

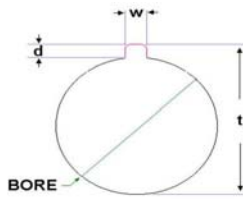

AGMA 9002-A86 Inch Bore and ANSI B17.1 Square Keyway Tolerances

Bore Diameter Size			Bore	Keyway Width (w)		Keyway Height (d) Reference	(t) - DIM -0.000 / +0.010
1 3/8	1.3750	<u>Minimum</u> <u>Maximum</u>	<u>1.3750</u> <u>1.3760</u>	5/16	<u>0.3125</u> <u>0.3145</u>	0.1563	<u>1.518</u> <u>1.528</u>
1 7/16	1.4375	<u>Minimum</u> <u>Maximum</u>	<u>1.4375</u> <u>1.4385</u>	3/8	<u>0.3750</u> <u>0.3770</u>	0.1875	<u>1.605</u> <u>1.615</u>
1 1/2	1.5000	<u>Minimum</u> <u>Maximum</u>	<u>1.5000</u> <u>1.5010</u>	3/8	<u>0.3750</u> <u>0.3770</u>	0.1875	<u>1.669</u> <u>1.679</u>
1 9/16	1.5625	<u>Minimum</u> <u>Maximum</u>	<u>1.5625</u> <u>1.5635</u>	3/8	<u>0.3750</u> <u>0.3770</u>	0.1875	<u>1.732</u> <u>1.742</u>
1 5/8	1.6250	<u>Minimum</u> <u>Maximum</u>	<u>1.6250</u> <u>1.6260</u>	3/8	<u>0.3750</u> <u>0.3770</u>	0.1875	<u>1.796</u> <u>1.806</u>
1 11/16	1.6875	<u>Minimum</u> <u>Maximum</u>	<u>1.6875</u> <u>1.6885</u>	3/8	<u>0.3750</u> <u>0.3770</u>	0.1875	<u>1.859</u> <u>1.869</u>
1 3/4	1.7500	<u>Minimum</u> <u>Maximum</u>	<u>1.7500</u> <u>1.7510</u>	3/8	<u>0.3750</u> <u>0.3770</u>	0.1875	<u>1.922</u> <u>1.932</u>
1 13/16	1.8125	<u>Minimum</u> <u>Maximum</u>	<u>1.8125</u> <u>1.8135</u>	1/2	<u>0.5000</u> <u>0.5020</u>	0.2500	<u>2.032</u> <u>2.042</u>
1 7/8	1.8750	<u>Minimum</u> <u>Maximum</u>	<u>1.8750</u> <u>1.8760</u>	1/2	<u>0.5000</u> <u>0.5020</u>	0.2500	<u>2.096</u> <u>2.106</u>
1 15/16	1.9375	<u>Minimum</u> <u>Maximum</u>	<u>1.9375</u> <u>1.9385</u>	1/2	<u>0.5000</u> <u>0.5020</u>	0.2500	<u>2.160</u> <u>2.170</u>
2.0000	2.0000	<u>Minimum</u> <u>Maximum</u>	<u>2.0000</u> <u>2.0010</u>	1/2	<u>0.5000</u> <u>0.5020</u>	0.2500	<u>2.223</u> <u>2.233</u>
2 1/16	2.0625	<u>Minimum</u> <u>Maximum</u>	<u>2.0625</u> <u>2.0640</u>	1/2	<u>0.5000</u> <u>0.5020</u>	0.2500	<u>2.287</u> <u>2.297</u>
2 1/8	2.1250	<u>Minimum</u> <u>Maximum</u>	<u>2.1250</u> <u>2.1265</u>	1/2	<u>0.5000</u> <u>0.5020</u>	0.2500	<u>2.350</u> <u>2.360</u>
2 3/16	2.1875	<u>Minimum</u> <u>Maximum</u>	<u>2.1875</u> <u>2.1890</u>	1/2	<u>0.5000</u> <u>0.5020</u>	0.2500	<u>2.414</u> <u>2.424</u>
2 1/4	2.2500	<u>Minimum</u> <u>Maximum</u>	<u>2.2500</u> <u>2.2515</u>	1/2	<u>0.5000</u> <u>0.5020</u>	0.2500	<u>2.477</u> <u>2.487</u>
2 5/16	2.3125	<u>Minimum</u> <u>Maximum</u>	<u>2.3125</u> <u>2.3140</u>	5/8	<u>0.6250</u> <u>0.6280</u>	0.3125	<u>2.587</u> <u>2.597</u>

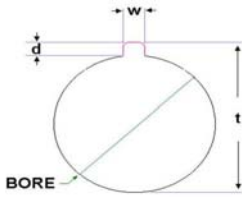

AGMA 9002-A86 Inch Bore and ANSI B17.1 Square Keyway Tolerances

Bore Diameter Size			Bore	Keyway Width (w)		Keyway Height (d) Reference	(t) - DIM -0.000 / +0.010
2 3/8	2.3750	<u>Minimum</u> Maximum	<u>2.3750</u> 2.3765	5/8	<u>0.6250</u> 0.6280	0.3125	<u>2.651</u> 2.661
2 7/16	2.4375	<u>Minimum</u> Maximum	<u>2.4375</u> 2.4390	5/8	<u>0.6250</u> 0.6280	0.3125	<u>2.714</u> 2.724
2 1/2	2.5000	<u>Minimum</u> Maximum	<u>2.5000</u> 2.5015	5/8	<u>0.6250</u> 0.6280	0.3125	<u>2.778</u> 2.788
2 9/16	2.5625	<u>Minimum</u> Maximum	<u>2.5625</u> 2.5640	5/8	<u>0.6250</u> 0.6280	0.3125	<u>2.841</u> 2.851
2 5/8	2.6250	<u>Minimum</u> Maximum	<u>2.6250</u> 2.6265	5/8	<u>0.6250</u> 0.6280	0.3125	<u>2.905</u> 2.915
2 11/16	2.6875	<u>Minimum</u> Maximum	<u>2.6875</u> 2.6890	5/8	<u>0.6250</u> 0.6280	0.3125	<u>2.968</u> 2.978
2 3/4	2.7500	<u>Minimum</u> Maximum	<u>2.7500</u> 2.7515	5/8	<u>0.6250</u> 0.6280	0.3125	<u>3.032</u> 3.042
2 13/16	2.8125	<u>Minimum</u> Maximum	<u>2.8125</u> 2.8140	3/4	<u>0.7500</u> 0.7530	0.3750	<u>3.142</u> 3.152
2 7/8	2.8750	<u>Minimum</u> Maximum	<u>2.8750</u> 2.8765	3/4	<u>0.7500</u> 0.7530	0.3750	<u>3.205</u> 3.215
2 15/16	2.9375	<u>Minimum</u> Maximum	<u>2.9375</u> 2.9390	3/4	<u>0.7500</u> 0.7530	0.3750	<u>3.269</u> 3.279
3.0000	3.0000	<u>Minimum</u> Maximum	<u>3.0000</u> 3.0015	3/4	<u>0.7500</u> 0.7530	0.3750	<u>3.332</u> 3.342
3 1/16	3.0625	<u>Minimum</u> Maximum	<u>3.0625</u> 3.0640	3/4	<u>0.7500</u> 0.7530	0.3750	<u>3.396</u> 3.406
3 1/8	3.1250	<u>Minimum</u> Maximum	<u>3.1250</u> 3.1265	3/4	<u>0.7500</u> 0.7530	0.3750	<u>3.459</u> 3.469
3 3/16	3.1875	<u>Minimum</u> Maximum	<u>3.1875</u> 3.1890	3/4	<u>0.7500</u> 0.7530	0.3750	<u>3.523</u> 3.533
3 1/4	3.2500	<u>Minimum</u> Maximum	<u>3.2500</u> 3.2515	3/4	<u>0.7500</u> 0.7530	0.3750	<u>3.586</u> 3.596
3 5/16	3.3125	<u>Minimum</u> Maximum	<u>3.3125</u> 3.3140	7/8	<u>0.8750</u> 0.8780	0.4375	<u>3.696</u> 3.706

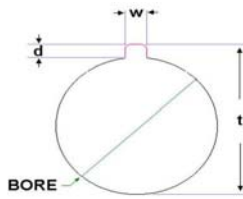

AGMA 9002-A86 Inch Bore and ANSI B17.1 Square Keyway Tolerances

Bore Diameter Size			Bore	Keyway Width (w)		Keyway Height (d) Reference	(t) - DIM -0.000 / +0.010
3 3/8	3.3750	<u>Minimum</u> Maximum	<u>3.3750</u> 3.3765	7/8	<u>0.8750</u> 0.8780	0.4375	<u>3.760</u> 3.770
3 7/16	3.4375	<u>Minimum</u> Maximum	<u>3.4375</u> 3.4390	7/8	<u>0.8750</u> 0.8780	0.4375	<u>3.823</u> 3.833
3 1/2	3.5000	<u>Minimum</u> Maximum	<u>3.5000</u> 3.5015	7/8	<u>0.8750</u> 0.8780	0.4375	<u>3.887</u> 3.897
3 9/16	3.5625	<u>Minimum</u> Maximum	<u>3.5625</u> 3.5640	7/8	<u>0.8750</u> 0.8780	0.4375	<u>3.950</u> 3.960
3 5/8	3.6250	<u>Minimum</u> Maximum	<u>3.6250</u> 3.6265	7/8	<u>0.8750</u> 0.8780	0.4375	<u>4.014</u> 4.024
3 11/16	3.6875	<u>Minimum</u> Maximum	<u>3.6875</u> 3.6890	7/8	<u>0.8750</u> 0.8780	0.4375	<u>4.077</u> 4.087
3 3/4	3.7500	<u>Minimum</u> Maximum	<u>3.7500</u> 3.7515	7/8	<u>0.8750</u> 0.8780	0.4375	<u>4.141</u> 4.151
3 13/16	3.8125	<u>Minimum</u> Maximum	<u>3.8125</u> 3.8140	1	<u>1.0000</u> 1.0030	0.5000	<u>4.251</u> 4.261
3 7/8	3.8750	<u>Minimum</u> Maximum	<u>3.8750</u> 3.8765	1	<u>1.0000</u> 1.0030	0.5000	<u>4.314</u> 4.324
3 15/16	3.9375	<u>Minimum</u> Maximum	<u>3.9375</u> 3.9390	1	<u>1.0000</u> 1.0030	0.5000	<u>4.378</u> 4.388
4.0000	4.0000	<u>Minimum</u> Maximum	<u>4.0000</u> 4.0015	1	<u>1.0000</u> 1.0030	0.5000	<u>4.441</u> 4.451
4 1/16	4.0625	<u>Minimum</u> Maximum	<u>4.0625</u> 4.0645	1	<u>1.0000</u> 1.0030	0.5000	<u>4.505</u> 4.515
4 1/8	4.1250	<u>Minimum</u> Maximum	<u>4.1250</u> 4.1270	1	<u>1.0000</u> 1.0030	0.5000	<u>4.568</u> 4.578
4 3/16	4.1875	<u>Minimum</u> Maximum	<u>4.1875</u> 4.1895	1	<u>1.0000</u> 1.0030	0.5000	<u>4.632</u> 4.642
4 1/4	4.2500	<u>Minimum</u> Maximum	<u>4.2500</u> 4.2520	1	<u>1.0000</u> 1.0030	0.5000	<u>4.695</u> 4.705
4 5/16	4.3125	<u>Minimum</u> Maximum	<u>4.3125</u> 4.3145	1	<u>1.0000</u> 1.0030	0.5000	<u>4.759</u> 4.769

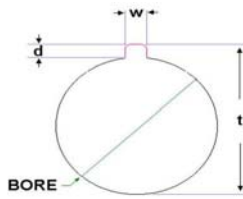

AGMA 9002-A86 Inch Bore and ANSI B17.1 Square Keyway Tolerances

Bore Diameter Size			Bore	Keyway Width (w)		Keyway Height (d) Reference	(t) - DIM -0.000 / +0.010
4 3/8	4.3750	<u>Minimum</u> Maximum	<u>4.3750</u> 4.3770	1	<u>1.0000</u> 1.0030	0.5000	<u>4.822</u> 4.832
4 7/16	4.4375	<u>Minimum</u> Maximum	<u>4.4375</u> 4.4395	1	<u>1.0000</u> 1.0030	0.5000	<u>4.885</u> 4.895
4 1/2	4.5000	<u>Minimum</u> Maximum	<u>4.5000</u> 4.5020	1	<u>1.0000</u> 1.0030	0.5000	<u>4.949</u> 4.959
4 9/16	4.5625	<u>Minimum</u> Maximum	<u>4.5625</u> 4.5645	1 1/4	<u>1.2500</u> 1.2540	0.6250	<u>5.105</u> 5.115
4 5/8	4.6250	<u>Minimum</u> Maximum	<u>4.6250</u> 4.6270	1 1/4	<u>1.2500</u> 1.2540	0.6250	<u>5.169</u> 5.179
4 11/16	4.6875	<u>Minimum</u> Maximum	<u>4.6875</u> 4.6895	1 1/4	<u>1.2500</u> 1.2540	0.6250	<u>5.233</u> 5.243
4 3/4	4.7500	<u>Minimum</u> Maximum	<u>4.7500</u> 4.7520	1 1/4	<u>1.2500</u> 1.2540	0.6250	<u>5.296</u> 5.306
4 13/16	4.8125	<u>Minimum</u> Maximum	<u>4.8125</u> 4.8145	1 1/4	<u>1.2500</u> 1.2540	0.6250	<u>5.360</u> 5.370
4 7/8	4.8750	<u>Minimum</u> Maximum	<u>4.8750</u> 4.8770	1 1/4	<u>1.2500</u> 1.2540	0.6250	<u>5.424</u> 5.434
4 15/16	4.9375	<u>Minimum</u> Maximum	<u>4.9375</u> 4.9395	1 1/4	<u>1.2500</u> 1.2540	0.6250	<u>5.487</u> 5.497
5.0000	5.0000	<u>Minimum</u> Maximum	<u>5.0000</u> 5.0020	1 1/4	<u>1.2500</u> 1.2540	0.6250	<u>5.551</u> 5.561
5 1/16	5.0625	<u>Minimum</u> Maximum	<u>5.0625</u> 5.0645	1 1/4	<u>1.2500</u> 1.2540	0.6250	<u>5.614</u> 5.624
5 1/8	5.1250	<u>Minimum</u> Maximum	<u>5.1250</u> 5.1270	1 1/4	<u>1.2500</u> 1.2540	0.6250	<u>5.678</u> 5.688
5 3/16	5.1875	<u>Minimum</u> Maximum	<u>5.1875</u> 5.1895	1 1/4	<u>1.2500</u> 1.2540	0.6250	<u>5.741</u> 5.751
5 1/4	5.2500	<u>Minimum</u> Maximum	<u>5.2500</u> 5.2520	1 1/4	<u>1.2500</u> 1.2540	0.6250	<u>5.805</u> 5.815

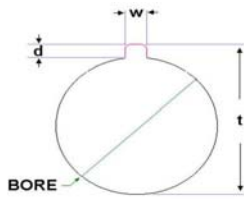

AGMA 9002-A86 Inch Bore and ANSI B17.1 Square Keyway Tolerances

Bore Diameter Size			Bore	Keyway Width (w)		Keyway Height (d) Reference	(t) - DIM -0.000 / +0.010
5 5/16	5.3125	<u>Minimum</u> <u>Maximum</u>	<u>5.3125</u> <u>5.3145</u>	1 1/4	<u>1.2500</u> <u>1.2540</u>	0.6250	<u>5.868</u> <u>5.878</u>
5 3/8	5.3750	<u>Minimum</u> <u>Maximum</u>	<u>5.3750</u> <u>5.3770</u>	1 1/4	<u>1.2500</u> <u>1.2540</u>	0.6250	<u>5.931</u> <u>5.941</u>
5 7/16	5.4375	<u>Minimum</u> <u>Maximum</u>	<u>5.4375</u> <u>5.4395</u>	1 1/4	<u>1.2500</u> <u>1.2540</u>	0.6250	<u>5.995</u> <u>6.005</u>
5 1/2	5.5000	<u>Minimum</u> <u>Maximum</u>	<u>5.5000</u> <u>5.5020</u>	1 1/4	<u>1.2500</u> <u>1.2540</u>	0.6250	<u>6.058</u> <u>6.068</u>