

DIN 7154, H7 Metric Bore and DIN 6885, Js9 Square Keyway Tolerances

		Bore (inches)	Keyway Width (w)	Keyway Height (d) Reference	(t) - DIM
8mm	Minimum	<u>0.315</u>	2mm <u>0.078</u>	1mm	<u>0.354</u>
	Maximum	0.316	0.079		0.358
9mm	Minimum	<u>0.354</u>	3mm <u>0.118</u>	1.4mm	<u>0.409</u>
	Maximum	0.355	0.119		0.413
10mm	Minimum	<u>0.394</u>	3mm <u>0.118</u>	1.4mm	<u>0.449</u>
	Maximum	0.394	0.119		0.453
11mm	Minimum	<u>0.433</u>	4mm <u>0.157</u>	1.8mm	<u>0.504</u>
	Maximum	0.434	0.158		0.508
12mm	Minimum	<u>0.472</u>	4mm <u>0.157</u>	1.8mm	<u>0.543</u>
	Maximum	0.473	0.158		0.547
14mm	Minimum	<u>0.551</u>	5mm <u>0.196</u>	2.3mm	<u>0.642</u>
	Maximum	0.552	0.197		0.646
15mm	Minimum	<u>0.591</u>	5mm <u>0.196</u>	2.3mm	<u>0.681</u>
	Maximum	0.591	0.197		0.685
16mm	Minimum	<u>0.630</u>	5mm <u>0.196</u>	2.3mm	<u>0.720</u>
	Maximum	0.631	0.197		0.724
17mm	Minimum	<u>0.669</u>	5mm <u>0.196</u>	2.3mm	<u>0.760</u>
	Maximum	0.670	0.197		0.764
19mm	Minimum	<u>0.748</u>	6mm <u>0.236</u>	2.8mm	<u>0.858</u>
	Maximum	0.749	0.237		0.862
20mm	Minimum	<u>0.787</u>	6mm <u>0.236</u>	2.8mm	<u>0.898</u>
	Maximum	0.788	0.237		0.902
22mm	Minimum	<u>0.866</u>	6mm <u>0.236</u>	2.8mm	<u>0.976</u>
	Maximum	0.867	0.237		0.980
24mm	Minimum	<u>0.945</u>	8mm <u>0.314</u>	3.3mm	<u>1.075</u>
	Maximum	0.946	0.316		1.083
25mm	Minimum	<u>0.984</u>	8mm <u>0.314</u>	3.3mm	<u>1.114</u>
	Maximum	0.985	0.316		1.122
28mm	Minimum	<u>1.102</u>	8mm <u>0.314</u>	3.3mm	<u>1.232</u>
	Maximum	1.103	0.316		1.240
30mm	Minimum	<u>1.181</u>	8mm <u>0.314</u>	3.3mm	<u>1.311</u>
	Maximum	1.182	0.316		1.319

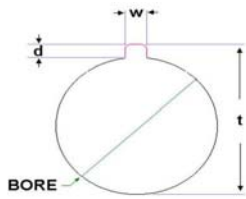

DIN 7154, H7 Metric Bore and DIN 6885, Js9 Square Keyway Tolerances

		Bore (inches)	Keyway Width (w)	Keyway Height (d) Reference	(t) - DIM
32mm	Minimum	<u>1.260</u>	10mm <u>0.393</u>	3.3mm	<u>1.390</u>
	Maximum	1.261	0.394		1.398
35mm	Minimum	<u>1.378</u>	10mm <u>0.393</u>	3.3mm	<u>1.508</u>
	Maximum	1.379	0.394		1.516
38mm	Minimum	<u>1.496</u>	10mm <u>0.393</u>	3.3mm	<u>1.626</u>
	Maximum	1.497	0.394		1.634
40mm	Minimum	<u>1.575</u>	12mm <u>0.472</u>	3.3mm	<u>1.705</u>
	Maximum	1.576	0.473		1.713
42mm	Minimum	<u>1.654</u>	12mm <u>0.472</u>	3.3mm	<u>1.783</u>
	Maximum	1.655	0.473		1.791
45mm	Minimum	<u>1.772</u>	14mm <u>0.550</u>	3.8mm	<u>1.921</u>
	Maximum	1.773	0.552		1.929
48mm	Minimum	<u>1.890</u>	14mm <u>0.550</u>	3.8mm	<u>2.039</u>
	Maximum	1.891	0.552		2.047
50mm	Minimum	<u>1.969</u>	14mm <u>0.550</u>	3.8mm	<u>2.118</u>
	Maximum	1.969	0.552		2.126
52mm	Minimum	<u>2.047</u>	16mm <u>0.629</u>	4.3mm	<u>2.217</u>
	Maximum	2.048	0.631		2.224
55mm	Minimum	<u>2.165</u>	16mm <u>0.629</u>	4.3mm	<u>2.335</u>
	Maximum	2.167	0.631		2.343
58mm	Minimum	<u>2.283</u>	16mm <u>0.629</u>	4.3mm	<u>2.453</u>
	Maximum	2.285	0.631		2.461
60mm	Minimum	<u>2.362</u>	18mm <u>0.708</u>	4.4mm	<u>2.535</u>
	Maximum	2.363	0.710		2.543
62mm	Minimum	<u>2.441</u>	18mm <u>0.708</u>	4.4mm	<u>2.614</u>
	Maximum	2.442	0.710		2.622
65mm	Minimum	<u>2.559</u>	18mm <u>0.708</u>	4.4mm	<u>2.732</u>
	Maximum	2.560	0.710		2.740
68mm	Minimum	<u>2.677</u>	20mm <u>0.786</u>	4.9mm	<u>2.870</u>
	Maximum	2.678	0.788		2.878
72mm	Minimum	<u>2.835</u>	20mm <u>0.786</u>	4.9mm	<u>3.028</u>
	Maximum	2.836	0.788		3.035

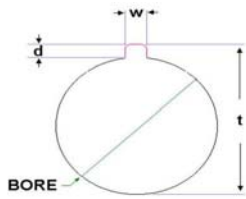

DIN 7154, H7 Metric Bore and DIN 6885, Js9 Square Keyway Tolerances

		Bore (inches)	Keyway Width (w)	Keyway Height (d) Reference	(t) - DIM
75mm	Minimum	<u>2.953</u>	20mm <u>0.786</u>	4.9mm	<u>3.146</u>
	Maximum	2.954	0.788		3.154
78mm	Minimum	<u>3.071</u>	22mm <u>0.865</u>	5.4mm	<u>3.283</u>
	Maximum	3.072	0.867		3.291
80mm	Minimum	<u>3.150</u>	22mm <u>0.865</u>	5.4mm	<u>3.362</u>
	Maximum	3.151	0.867		3.370
82mm	Minimum	<u>3.228</u>	22mm <u>0.865</u>	5.4mm	<u>3.441</u>
	Maximum	3.230	0.867		3.449
85mm	Minimum	<u>3.346</u>	22mm <u>0.865</u>	5.4mm	<u>3.559</u>
	Maximum	3.348	0.867		3.567
88mm	Minimum	<u>3.465</u>	25mm <u>0.983</u>	5.4mm	<u>3.677</u>
	Maximum	3.466	0.985		3.685
90mm	Minimum	<u>3.543</u>	25mm <u>0.983</u>	5.4mm	<u>3.756</u>
	Maximum	3.545	0.985		3.764
92mm	Minimum	<u>3.622</u>	25mm <u>0.983</u>	5.4mm	<u>3.835</u>
	Maximum	3.623	0.985		3.843
95mm	Minimum	<u>3.740</u>	25mm <u>0.983</u>	5.4mm	<u>3.953</u>
	Maximum	3.742	0.985		3.961
98mm	Minimum	<u>3.858</u>	28mm <u>1.101</u>	6.4mm	<u>4.110</u>
	Maximum	3.860	1.103		4.118
100mm	Minimum	<u>3.937</u>	28mm <u>1.101</u>	6.4mm	<u>4.189</u>
	Maximum	3.938	1.103		4.197
102mm	Minimum	<u>4.016</u>	28mm <u>1.101</u>	6.4mm	<u>4.268</u>
	Maximum	4.017	1.103		4.276
105mm	Minimum	<u>4.134</u>	28mm <u>1.101</u>	6.4mm	<u>4.386</u>
	Maximum	4.135	1.103		4.394
108mm	Minimum	<u>4.252</u>	28mm <u>1.101</u>	6.4mm	<u>4.504</u>
	Maximum	4.253	1.103		4.512
110mm	Minimum	<u>4.331</u>	28mm <u>1.101</u>	6.4mm	<u>4.583</u>
	Maximum	4.332	1.103		4.591