

**PFEIFER INDUSTRIES, LLC.**

2180 Corporate Lane, Suite 104 ~ Naperville, IL 60563 USA

Phone (630) 596-9000 Fax (630) 596-9002

E-mail: info@pfeiferindustries.com Web site: www.pfeiferindustries.com

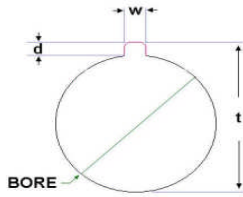

**AGMA 9002-A86 Inch Bore and ANSI B17.1  
Square Keyway Tolerances**

Bore Diameter Size			Bore	Keyway Width (w)		Keyway Height (d) Reference	(t) - DIM -0.000 / +0.010
3/8	.3750	<u>Minimum</u> <u>Maximum</u>	<u>0.3750</u> <u>0.3760</u>	3/32	<u>0.0938</u> <u>0.0958</u>	0.0469	<u>0.421</u> <u>0.431</u>
7/16	.4375	<u>Minimum</u> <u>Maximum</u>	<u>0.4375</u> <u>0.4385</u>	3/32	<u>0.0938</u> <u>0.0958</u>	0.0469	<u>0.484</u> <u>0.494</u>
1/2	0.5000	<u>Minimum</u> <u>Maximum</u>	<u>0.5000</u> <u>0.5010</u>	1/8	<u>0.1250</u> <u>0.1270</u>	0.0625	<u>0.560</u> <u>0.570</u>
9/16	.5625	<u>Minimum</u> <u>Maximum</u>	<u>0.5625</u> <u>0.5635</u>	1/8	<u>0.1250</u> <u>0.1270</u>	0.0625	<u>0.623</u> <u>0.633</u>
5/8	.6250	<u>Minimum</u> <u>Maximum</u>	<u>0.6250</u> <u>0.6260</u>	3/16	<u>0.1875</u> <u>0.1895</u>	0.0938	<u>0.709</u> <u>0.719</u>
11/16	.6875	<u>Minimum</u> <u>Maximum</u>	<u>0.6875</u> <u>0.6885</u>	3/16	<u>0.1875</u> <u>0.1895</u>	0.0938	<u>0.773</u> <u>0.783</u>
3/4	.7500	<u>Minimum</u> <u>Maximum</u>	<u>0.7500</u> <u>0.7510</u>	3/16	<u>0.1875</u> <u>0.1895</u>	0.0938	<u>0.837</u> <u>0.847</u>
13/16	.8125	<u>Minimum</u> <u>Maximum</u>	<u>0.8125</u> <u>0.8135</u>	3/16	<u>0.1875</u> <u>0.1895</u>	0.0938	<u>0.900</u> <u>0.910</u>
7/8	.8750	<u>Minimum</u> <u>Maximum</u>	<u>0.8750</u> <u>0.8760</u>	3/16	<u>0.1875</u> <u>0.1895</u>	0.0938	<u>0.964</u> <u>0.974</u>
15/16	.9375	<u>Minimum</u> <u>Maximum</u>	<u>0.9375</u> <u>0.9385</u>	1/4	<u>0.2500</u> <u>0.2520</u>	0.1250	<u>1.051</u> <u>1.061</u>
1.0000	1.0000	<u>Minimum</u> <u>Maximum</u>	<u>1.0000</u> <u>1.0010</u>	1/4	<u>0.2500</u> <u>0.2520</u>	0.1250	<u>1.114</u> <u>1.124</u>
1 1/16	1.0625	<u>Minimum</u> <u>Maximum</u>	<u>1.0625</u> <u>1.0635</u>	1/4	<u>0.2500</u> <u>0.2520</u>	0.1250	<u>1.178</u> <u>1.188</u>
1 1/8	1.1250	<u>Minimum</u> <u>Maximum</u>	<u>1.1250</u> <u>1.1260</u>	1/4	<u>0.2500</u> <u>0.2520</u>	0.1250	<u>1.241</u> <u>1.251</u>
1 3/16	1.1875	<u>Minimum</u> <u>Maximum</u>	<u>1.1875</u> <u>1.1885</u>	1/4	<u>0.2500</u> <u>0.2520</u>	0.1250	<u>1.304</u> <u>1.314</u>

**PFEIFER INDUSTRIES, LLC.**

2180 Corporate Lane, Suite 104 ~ Naperville, IL 60563 USA

Phone (630) 596-9000 Fax (630) 596-9002

E-mail: info@pfeiferindustries.com Web site: www.pfeiferindustries.com

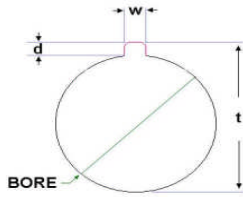

**AGMA 9002-A86 Inch Bore and ANSI B17.1  
Square Keyway Tolerances**

Bore Diameter Size				Bore	Keyway Width (w)		Keyway Height (d) Reference	(t) - DIM -0.000 / +0.010
1 1/4	1.2500	<u>Minimum</u> <u>Maximum</u>	<u>1.2500</u> <u>1.2510</u>	1/4	<u>0.2500</u> <u>0.2520</u>	0.1250	<u>1.367</u> <u>1.377</u>	
1 5/16	1.3125	<u>Minimum</u> <u>Maximum</u>	<u>1.3125</u> <u>1.3135</u>	5/16	<u>0.3125</u> <u>0.3145</u>	0.1563	<u>1.455</u> <u>1.465</u>	
1 3/8	1.3750	<u>Minimum</u> <u>Maximum</u>	<u>1.3750</u> <u>1.3760</u>	5/16	<u>0.3125</u> <u>0.3145</u>	0.1563	<u>1.518</u> <u>1.528</u>	
1 7/16	1.4375	<u>Minimum</u> <u>Maximum</u>	<u>1.4375</u> <u>1.4385</u>	3/8	<u>0.3750</u> <u>0.3770</u>	0.1875	<u>1.605</u> <u>1.615</u>	
1 1/2	1.5000	<u>Minimum</u> <u>Maximum</u>	<u>1.5000</u> <u>1.5010</u>	3/8	<u>0.3750</u> <u>0.3770</u>	0.1875	<u>1.669</u> <u>1.679</u>	
1 9/16	1.5625	<u>Minimum</u> <u>Maximum</u>	<u>1.5625</u> <u>1.5635</u>	3/8	<u>0.3750</u> <u>0.3770</u>	0.1875	<u>1.732</u> <u>1.742</u>	
1 5/8	1.6250	<u>Minimum</u> <u>Maximum</u>	<u>1.6250</u> <u>1.6260</u>	3/8	<u>0.3750</u> <u>0.3770</u>	0.1875	<u>1.796</u> <u>1.806</u>	
1 11/16	1.6875	<u>Minimum</u> <u>Maximum</u>	<u>1.6875</u> <u>1.6885</u>	3/8	<u>0.3750</u> <u>0.3770</u>	0.1875	<u>1.859</u> <u>1.869</u>	
1 3/4	1.7500	<u>Minimum</u> <u>Maximum</u>	<u>1.7500</u> <u>1.7510</u>	3/8	<u>0.3750</u> <u>0.3770</u>	0.1875	<u>1.922</u> <u>1.932</u>	
1 13/16	1.8125	<u>Minimum</u> <u>Maximum</u>	<u>1.8125</u> <u>1.8135</u>	1/2	<u>0.5000</u> <u>0.5020</u>	0.2500	<u>2.032</u> <u>2.042</u>	
1 7/8	1.8750	<u>Minimum</u> <u>Maximum</u>	<u>1.8750</u> <u>1.8760</u>	1/2	<u>0.5000</u> <u>0.5020</u>	0.2500	<u>2.096</u> <u>2.106</u>	
1 15/16	1.9375	<u>Minimum</u> <u>Maximum</u>	<u>1.9375</u> <u>1.9385</u>	1/2	<u>0.5000</u> <u>0.5020</u>	0.2500	<u>2.160</u> <u>2.170</u>	
2.0000	2.0000	<u>Minimum</u> <u>Maximum</u>	<u>2.0000</u> <u>2.0010</u>	1/2	<u>0.5000</u> <u>0.5020</u>	0.2500	<u>2.223</u> <u>2.233</u>	
2 1/16	2.0625	<u>Minimum</u> <u>Maximum</u>	<u>2.0625</u> <u>2.0640</u>	1/2	<u>0.5000</u> <u>0.5020</u>	0.2500	<u>2.287</u> <u>2.297</u>	

**PFEIFER INDUSTRIES, LLC.**

2180 Corporate Lane, Suite 104 ~ Naperville, IL 60563 USA

Phone (630) 596-9000 Fax (630) 596-9002

E-mail: info@pfeiferindustries.com Web site: www.pfeiferindustries.com

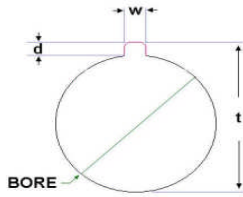

**AGMA 9002-A86 Inch Bore and ANSI B17.1  
Square Keyway Tolerances**

Bore Diameter Size			Bore	Keyway Width (w)		Keyway Height (d) Reference	(t) - DIM -0.000 / +0.010
2 1/8	2.1250	<u>Minimum</u> <u>Maximum</u>	<u>2.1250</u> <u>2.1265</u>	1/2	<u>0.5000</u> <u>0.5020</u>	0.2500	<u>2.350</u> <u>2.360</u>
2 3/16	2.1875	<u>Minimum</u> <u>Maximum</u>	<u>2.1875</u> <u>2.1890</u>	1/2	<u>0.5000</u> <u>0.5020</u>	0.2500	<u>2.414</u> <u>2.424</u>
2 1/4	2.2500	<u>Minimum</u> <u>Maximum</u>	<u>2.2500</u> <u>2.2515</u>	1/2	<u>0.5000</u> <u>0.5020</u>	0.2500	<u>2.477</u> <u>2.487</u>
2 5/16	2.3125	<u>Minimum</u> <u>Maximum</u>	<u>2.3125</u> <u>2.3140</u>	5/8	<u>0.6250</u> <u>0.6280</u>	0.3125	<u>2.587</u> <u>2.597</u>
2 3/8	2.3750	<u>Minimum</u> <u>Maximum</u>	<u>2.3750</u> <u>2.3765</u>	5/8	<u>0.6250</u> <u>0.6280</u>	0.3125	<u>2.651</u> <u>2.661</u>
2 7/16	2.4375	<u>Minimum</u> <u>Maximum</u>	<u>2.4375</u> <u>2.4390</u>	5/8	<u>0.6250</u> <u>0.6280</u>	0.3125	<u>2.714</u> <u>2.724</u>
2 1/2	2.5000	<u>Minimum</u> <u>Maximum</u>	<u>2.5000</u> <u>2.5015</u>	5/8	<u>0.6250</u> <u>0.6280</u>	0.3125	<u>2.778</u> <u>2.788</u>
2 9/16	2.5625	<u>Minimum</u> <u>Maximum</u>	<u>2.5625</u> <u>2.5640</u>	5/8	<u>0.6250</u> <u>0.6280</u>	0.3125	<u>2.841</u> <u>2.851</u>
2 5/8	2.6250	<u>Minimum</u> <u>Maximum</u>	<u>2.6250</u> <u>2.6265</u>	5/8	<u>0.6250</u> <u>0.6280</u>	0.3125	<u>2.905</u> <u>2.915</u>
2 11/16	2.6875	<u>Minimum</u> <u>Maximum</u>	<u>2.6875</u> <u>2.6890</u>	5/8	<u>0.6250</u> <u>0.6280</u>	0.3125	<u>2.968</u> <u>2.978</u>
2 3/4	2.7500	<u>Minimum</u> <u>Maximum</u>	<u>2.7500</u> <u>2.7515</u>	5/8	<u>0.6250</u> <u>0.6280</u>	0.3125	<u>3.032</u> <u>3.042</u>
2 13/16	2.8125	<u>Minimum</u> <u>Maximum</u>	<u>2.8125</u> <u>2.8140</u>	3/4	<u>0.7500</u> <u>0.7530</u>	0.3750	<u>3.142</u> <u>3.152</u>
2 7/8	2.8750	<u>Minimum</u> <u>Maximum</u>	<u>2.8750</u> <u>2.8765</u>	3/4	<u>0.7500</u> <u>0.7530</u>	0.3750	<u>3.205</u> <u>3.215</u>
2 15/16	2.9375	<u>Minimum</u> <u>Maximum</u>	<u>2.9375</u> <u>2.9390</u>	3/4	<u>0.7500</u> <u>0.7530</u>	0.3750	<u>3.269</u> <u>3.279</u>

**PFEIFER INDUSTRIES, LLC.**

2180 Corporate Lane, Suite 104 ~ Naperville, IL 60563 USA

Phone (630) 596-9000 Fax (630) 596-9002

E-mail: info@pfeiferindustries.com Web site: www.pfeiferindustries.com

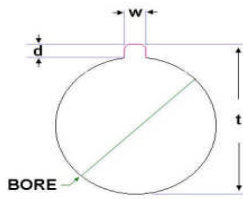

**AGMA 9002-A86 Inch Bore and ANSI B17.1  
Square Keyway Tolerances**

Bore Diameter Size			Bore	Keyway Width (w)		Keyway Height (d) Reference	(t) - DIM -0.000 / +0.010
3.0000	3.0000	<u>Minimum</u> <u>Maximum</u>	<u>3.0000</u> <u>3.0015</u>	3/4	<u>0.7500</u> <u>0.7530</u>	0.3750	<u>3.332</u> <u>3.342</u>
3 1/16	3.0625	<u>Minimum</u> <u>Maximum</u>	<u>3.0625</u> <u>3.0640</u>	3/4	<u>0.7500</u> <u>0.7530</u>	0.3750	<u>3.396</u> <u>3.406</u>
3 1/8	3.1250	<u>Minimum</u> <u>Maximum</u>	<u>3.1250</u> <u>3.1265</u>	3/4	<u>0.7500</u> <u>0.7530</u>	0.3750	<u>3.459</u> <u>3.469</u>
3 3/16	3.1875	<u>Minimum</u> <u>Maximum</u>	<u>3.1875</u> <u>3.1890</u>	3/4	<u>0.7500</u> <u>0.7530</u>	0.3750	<u>3.523</u> <u>3.533</u>
3 1/4	3.2500	<u>Minimum</u> <u>Maximum</u>	<u>3.2500</u> <u>3.2515</u>	3/4	<u>0.7500</u> <u>0.7530</u>	0.3750	<u>3.586</u> <u>3.596</u>
3 5/16	3.3125	<u>Minimum</u> <u>Maximum</u>	<u>3.3125</u> <u>3.3140</u>	7/8	<u>0.8750</u> <u>0.8780</u>	0.4375	<u>3.696</u> <u>3.706</u>
3 3/8	3.3750	<u>Minimum</u> <u>Maximum</u>	<u>3.3750</u> <u>3.3765</u>	7/8	<u>0.8750</u> <u>0.8780</u>	0.4375	<u>3.760</u> <u>3.770</u>
3 7/16	3.4375	<u>Minimum</u> <u>Maximum</u>	<u>3.4375</u> <u>3.4390</u>	7/8	<u>0.8750</u> <u>0.8780</u>	0.4375	<u>3.823</u> <u>3.833</u>
3 1/2	3.5000	<u>Minimum</u> <u>Maximum</u>	<u>3.5000</u> <u>3.5015</u>	7/8	<u>0.8750</u> <u>0.8780</u>	0.4375	<u>3.887</u> <u>3.897</u>
3 9/16	3.5625	<u>Minimum</u> <u>Maximum</u>	<u>3.5625</u> <u>3.5640</u>	7/8	<u>0.8750</u> <u>0.8780</u>	0.4375	<u>3.950</u> <u>3.960</u>
3 5/8	3.6250	<u>Minimum</u> <u>Maximum</u>	<u>3.6250</u> <u>3.6265</u>	7/8	<u>0.8750</u> <u>0.8780</u>	0.4375	<u>4.014</u> <u>4.024</u>
3 11/16	3.6875	<u>Minimum</u> <u>Maximum</u>	<u>3.6875</u> <u>3.6890</u>	7/8	<u>0.8750</u> <u>0.8780</u>	0.4375	<u>4.077</u> <u>4.087</u>
3 3/4	3.7500	<u>Minimum</u> <u>Maximum</u>	<u>3.7500</u> <u>3.7515</u>	7/8	<u>0.8750</u> <u>0.8780</u>	0.4375	<u>4.141</u> <u>4.151</u>
3 13/16	3.8125	<u>Minimum</u> <u>Maximum</u>	<u>3.8125</u> <u>3.8140</u>	1	<u>1.0000</u> <u>1.0030</u>	0.5000	<u>4.251</u> <u>4.261</u>

**PFEIFER INDUSTRIES, LLC.**

2180 Corporate Lane, Suite 104 ~ Naperville, IL 60563 USA

Phone (630) 596-9000 Fax (630) 596-9002

E-mail: info@pfeiferindustries.com Web site: www.pfeiferindustries.com

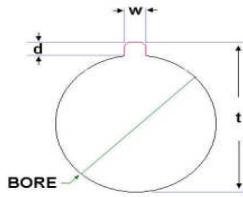

**AGMA 9002-A86 Inch Bore and ANSI B17.1  
Square Keyway Tolerances**

Bore Diameter Size			Bore	Keyway Width (w)		Keyway Height (d) Reference	(t) - DIM -0.000 / +0.010
3 7/8	3.8750	<u>Minimum</u> <u>Maximum</u>	<u>3.8750</u> <u>3.8765</u>	1	<u>1.0000</u> <u>1.0030</u>	0.5000	<u>4.314</u> <u>4.324</u>
3 15/16	3.9375	<u>Minimum</u> <u>Maximum</u>	<u>3.9375</u> <u>3.9390</u>	1	<u>1.0000</u> <u>1.0030</u>	0.5000	<u>4.378</u> <u>4.388</u>
4.0000	4.0000	<u>Minimum</u> <u>Maximum</u>	<u>4.0000</u> <u>4.0015</u>	1	<u>1.0000</u> <u>1.0030</u>	0.5000	<u>4.441</u> <u>4.451</u>
4 1/16	4.0625	<u>Minimum</u> <u>Maximum</u>	<u>4.0625</u> <u>4.0645</u>	1	<u>1.0000</u> <u>1.0030</u>	0.5000	<u>4.505</u> <u>4.515</u>
4 1/8	4.1250	<u>Minimum</u> <u>Maximum</u>	<u>4.1250</u> <u>4.1270</u>	1	<u>1.0000</u> <u>1.0030</u>	0.5000	<u>4.568</u> <u>4.578</u>
4 3/16	4.1875	<u>Minimum</u> <u>Maximum</u>	<u>4.1875</u> <u>4.1895</u>	1	<u>1.0000</u> <u>1.0030</u>	0.5000	<u>4.632</u> <u>4.642</u>
4 1/4	4.2500	<u>Minimum</u> <u>Maximum</u>	<u>4.2500</u> <u>4.2520</u>	1	<u>1.0000</u> <u>1.0030</u>	0.5000	<u>4.695</u> <u>4.705</u>
4 5/16	4.3125	<u>Minimum</u> <u>Maximum</u>	<u>4.3125</u> <u>4.3145</u>	1	<u>1.0000</u> <u>1.0030</u>	0.5000	<u>4.759</u> <u>4.769</u>
4 3/8	4.3750	<u>Minimum</u> <u>Maximum</u>	<u>4.3750</u> <u>4.3770</u>	1	<u>1.0000</u> <u>1.0030</u>	0.5000	<u>4.822</u> <u>4.832</u>
4 7/16	4.4375	<u>Minimum</u> <u>Maximum</u>	<u>4.4375</u> <u>4.4395</u>	1	<u>1.0000</u> <u>1.0030</u>	0.5000	<u>4.885</u> <u>4.895</u>
4 1/2	4.5000	<u>Minimum</u> <u>Maximum</u>	<u>4.5000</u> <u>4.5020</u>	1	<u>1.0000</u> <u>1.0030</u>	0.5000	<u>4.949</u> <u>4.959</u>
4 9/16	4.5625	<u>Minimum</u> <u>Maximum</u>	<u>4.5625</u> <u>4.5645</u>	1 1/4	<u>1.2500</u> <u>1.2540</u>	0.6250	<u>5.105</u> <u>5.115</u>
4 5/8	4.6250	<u>Minimum</u> <u>Maximum</u>	<u>4.6250</u> <u>4.6270</u>	1 1/4	<u>1.2500</u> <u>1.2540</u>	0.6250	<u>5.169</u> <u>5.179</u>
4 11/16	4.6875	<u>Minimum</u> <u>Maximum</u>	<u>4.6875</u> <u>4.6895</u>	1 1/4	<u>1.2500</u> <u>1.2540</u>	0.6250	<u>5.233</u> <u>5.243</u>

**PFEIFER INDUSTRIES, LLC.**

2180 Corporate Lane, Suite 104 ~ Naperville, IL 60563 USA

Phone (630) 596-9000 Fax (630) 596-9002

E-mail: info@pfeiferindustries.com Web site: www.pfeiferindustries.com

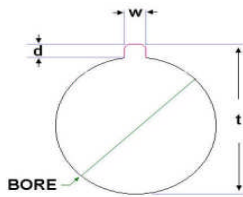

**AGMA 9002-A86 Inch Bore and ANSI B17.1  
Square Keyway Tolerances**

Bore Diameter Size			Bore	Keyway Width (w)		Keyway Height (d) Reference	(t) - DIM -0.000 / +0.010
4 3/4	4.7500	<u>Minimum</u> <u>Maximum</u>	<u>4.7500</u> <u>4.7520</u>	1 1/4	<u>1.2500</u> <u>1.2540</u>	0.6250	<u>5.296</u> <u>5.306</u>
4 13/16	4.8125	<u>Minimum</u> <u>Maximum</u>	<u>4.8125</u> <u>4.8145</u>	1 1/4	<u>1.2500</u> <u>1.2540</u>	0.6250	<u>5.360</u> <u>5.370</u>
4 7/8	4.8750	<u>Minimum</u> <u>Maximum</u>	<u>4.8750</u> <u>4.8770</u>	1 1/4	<u>1.2500</u> <u>1.2540</u>	0.6250	<u>5.424</u> <u>5.434</u>
4 15/16	4.9375	<u>Minimum</u> <u>Maximum</u>	<u>4.9375</u> <u>4.9395</u>	1 1/4	<u>1.2500</u> <u>1.2540</u>	0.6250	<u>5.487</u> <u>5.497</u>
5.0000	5.0000	<u>Minimum</u> <u>Maximum</u>	<u>5.0000</u> <u>5.0020</u>	1 1/4	<u>1.2500</u> <u>1.2540</u>	0.6250	<u>5.551</u> <u>5.561</u>
5 1/16	5.0625	<u>Minimum</u> <u>Maximum</u>	<u>5.0625</u> <u>5.0645</u>	1 1/4	<u>1.2500</u> <u>1.2540</u>	0.6250	<u>5.614</u> <u>5.624</u>
5 1/8	5.1250	<u>Minimum</u> <u>Maximum</u>	<u>5.1250</u> <u>5.1270</u>	1 1/4	<u>1.2500</u> <u>1.2540</u>	0.6250	<u>5.678</u> <u>5.688</u>
5 3/16	5.1875	<u>Minimum</u> <u>Maximum</u>	<u>5.1875</u> <u>5.1895</u>	1 1/4	<u>1.2500</u> <u>1.2540</u>	0.6250	<u>5.741</u> <u>5.751</u>
5 1/4	5.2500	<u>Minimum</u> <u>Maximum</u>	<u>5.2500</u> <u>5.2520</u>	1 1/4	<u>1.2500</u> <u>1.2540</u>	0.6250	<u>5.805</u> <u>5.815</u>
5 5/16	5.3125	<u>Minimum</u> <u>Maximum</u>	<u>5.3125</u> <u>5.3145</u>	1 1/4	<u>1.2500</u> <u>1.2540</u>	0.6250	<u>5.868</u> <u>5.878</u>
5 3/8	5.3750	<u>Minimum</u> <u>Maximum</u>	<u>5.3750</u> <u>5.3770</u>	1 1/4	<u>1.2500</u> <u>1.2540</u>	0.6250	<u>5.931</u> <u>5.941</u>
5 7/16	5.4375	<u>Minimum</u> <u>Maximum</u>	<u>5.4375</u> <u>5.4395</u>	1 1/4	<u>1.2500</u> <u>1.2540</u>	0.6250	<u>5.995</u> <u>6.005</u>
5 1/2	5.5000	<u>Minimum</u> <u>Maximum</u>	<u>5.5000</u> <u>5.5020</u>	1 1/4	<u>1.2500</u> <u>1.2540</u>	0.6250	<u>6.058</u> <u>6.068</u>